

SYNTEX® standard flange coupling (design 001)

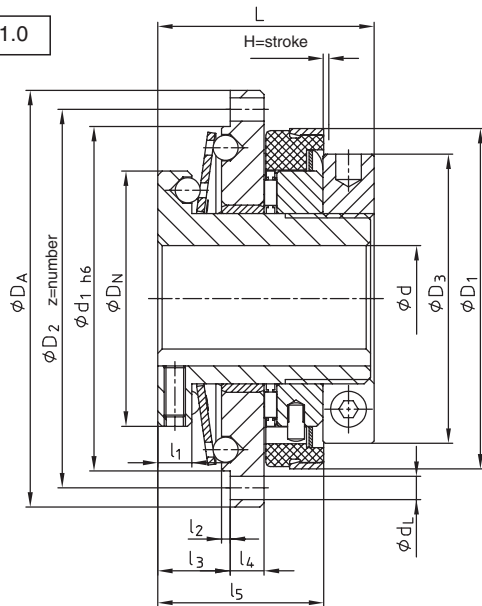

- SYNTEX® standard safety clutch applicable up to 400 Nm
- Flange design
- Easy mounting of customers' components
- Available both as a ratchet and synchronous design
- Torque setting possible while in place
- Finish bore according to ISO fit H7, feather keyway according to DIN 6885 sheet 1 - JS9
- Also available with a frictionally engaged shaft-hub-connection (hub design 4.5)

Hub design 1.0



Hub design 4.5

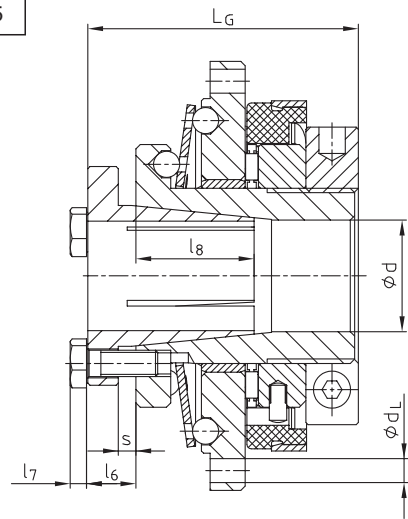

SYNTEX® Size	Torques [Nm]				Dimensions [mm]																
	Ratchet design DK		Synchr. design SK		Bore d		DA	D2	d1	DN	D3	D1	dI	L	l1	l2	l3	l4	l5	z	H = stroke
	DK1	DK2	SK 1	SK 2	Pilot bore	max.															
20	6–20	15–30	10–20	20–65	–	20	80	71	65	48	47	61	4,5	45	8	2	16	6	35	8	2
25	20–60	45–90	25–65	40–100	–	25	98	89	81	60	60	78	5,5	50	8	2	17	8	39	8	2
35	25–80	75–150	30–100	70–180	–	35	120	110	102	75	70	90	5,5	60	10	2	21	10	42	12	2
50	60–180	175–300	80–280	160–400	–	50	162	152	142	105	98	120	6,6	70	12	2	25	13	56	12	2

Hub design 4.5

SYNTEX® Size	Dimensions [mm]							Tightening torques TA [Nm]
	dmax.	l6	l7	l8	LG	s	Clamping screws	
20	20	9	3,5	23	54	3	4 x M 5	8,5
25	25	11	4	28	61	4	4 x M 6	14
35	35	10	4	31	70	4	4 x M 6	14
50	50	12	4	37	82	6	4 x M 6	14

Order form:

SYNTEX®	25	DK 1	Ø 20	1.0	45 Nm
Coupling type	Size	Design	Bore	Hub design	Torque set